

# SCRIPT TABLE ASSEMBLY INSTRUCTIONS



## TOOLS NEEDED

4mm Across Flats Allen Key

Rubber Mallet

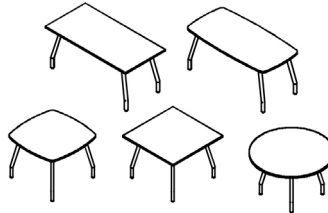
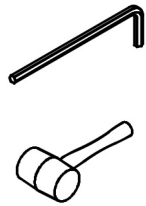

Used on Script 727 High Tables

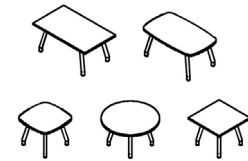

Used on Script Occasional Tables

## PARTS LIST

Script Tables are available in two styles (Angled or Straight)

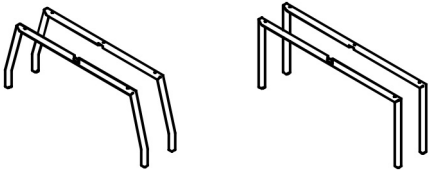

Both leg styles are assembled in the same way. Angled leg shown for clarity.

**A** Leg Top Frame x1

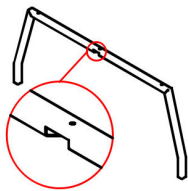

**B** Leg Bottom Frame x1

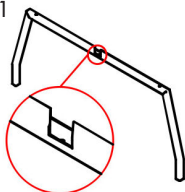

**C** M6 x 60 Flange Head Bolt x5



**D** Top Panel x1

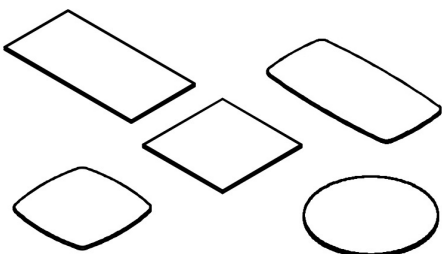

## INSTRUCTIONS

**1** LAY THE TOP FACE DOWN ON THE FLOOR

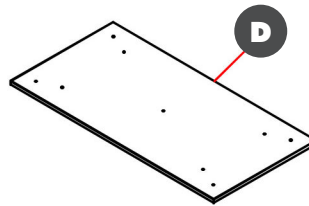

**2** SLOT THE LEGS TOGETHER  
SLOT THE LEG FRAMES TOGETHER TO CREATE THE LEG ASSEMBLY

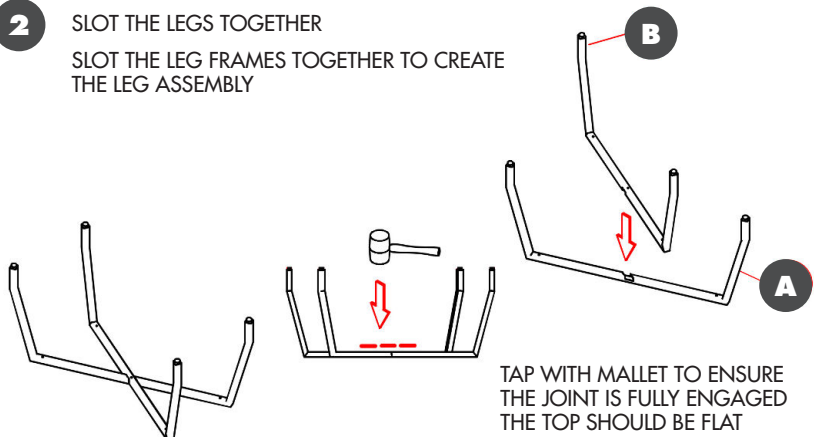

**3** BOLT LEG ASSEMBLY TO THE TOP PANEL

